

TRAFX MANUAL

Part I

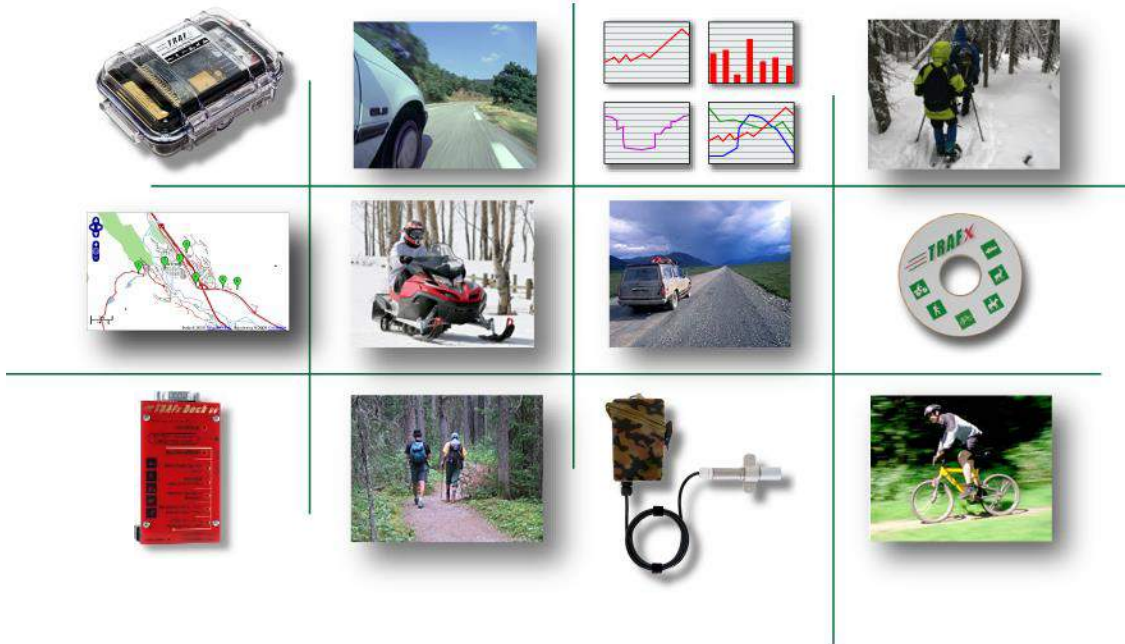

Advanced Counting Systems



www.trafx.net © 2001 - 2024

Tip!



Enjoy **Premium** technical support as a DataNet user.

See page 21



LIMITED WARRANTY

Products: By placing an Order, Buyer is deemed to have accepted the following warranty terms and other limitations. TRAFx warrants to Buyer that each Product shall be substantially free from defects in materials and workmanship under normal use for a period of one (1) year from the date on the Invoice (or for a period of five (5) years if TRAFx's optional extended limited warranty is purchased). The exclusive remedy and entire liability under this warranty will be for repair or replacement of the Product under warranty on a like-for-like basis, at TRAFx's sole option. TRAFx shall not have any obligation to repair or replace any Product under warranty until Buyer returns the warranted Product to TRAFx in accordance with these Terms and Conditions of Sale. This warranty shall not apply to any Product defects resulting from but not limited to the following: (a) improper maintenance or installation; (b) misuse, neglect or accident; (c) damage from moisture or corrosive environments; (d) electrostatic discharge; (e) operation outside the Products specification; (f) failure to follow Product instructions or (g) alterations or modifications made to the Product in any way.

EXCEPT FOR THE EXPRESS WARRANTIES SET FORTH ABOVE, AND TO THE EXTENT PERMITTED BY APPLICABLE LAW, THE PRODUCTS ARE SUPPLIED ON AN "AS IS" BASIS AND THERE ARE NO WARRANTIES, REPRESENTATIONS OR CONDITIONS, WHETHER EXPRESSED OR IMPLIED, WRITTEN OR ORAL, ARISING BY STATUTE, OPERATION OF LAW, COURSE OF DEALING, USAGE OF TRADE OR OTHERWISE, WITH RESPECT TO THE PRODUCT. TRAFx SPECIFICALLY DISCLAIMS ANY IMPLIED WARRANTIES OR CONDITIONS OF MERCHANTABILITY, AND NON-INFRINGEMENT.

This limited Product warranty applies solely to original Buyer and is non-transferable.

DataNet: For the sake of clarity the above Product warranty does not apply to DataNet, for which warranty terms are found in DataNet's Terms and Conditions of Use (see trafx.net/legal)

Third Party Merchandise: Third party merchandise (e.g., cables) carries different warranty terms than TRAFx Products. Any warranty and technical support provided for third party merchandise is provided by the original manufacturer, not by TRAFx and TRAFx shall use reasonable commercial efforts to transfer that warranty, if transferable.

Definitions:

"Buyer" means the person, organization or other legal entity that places an Order.

"Invoice" means the sales invoice issued by TRAFx to Buyer for the Items listed on the TRAFx Quote and Order Form.

"Items" means any quoted item listed on the TRAFx Quote and Order Form.

"Order" means the placement of an Order by Buyer to TRAFx by submitting a TRAFx Quote and Order Form or by submission or use of a purchase order or other procurement instrument or means, electronically or otherwise, which Order placement constitutes Buyer's irrevocable and binding agreement to abide by TRAFx's Terms and Conditions of Sale.

"Product(s)" means any product manufactured by TRAFx listed on the TRAFx Quote and Order Form, excluding DataNet.

"TRAFx" means TRAFx Research Ltd., a corporation registered in the province of Alberta (Canada).



In a nutshell, limited warranty period is normally 1 year and covers manufacturing defects.

Support and repairs



- For support, see p. 17, and also visit trafx.net/support
- Before sending something for repair contact us via trafx.net/support
- Download the latest versions of manuals and software at trafx.net/support

TRAFx Manual – PART I

CHAPTER 1 — INTRODUCTION 4

 1.1 Overview.....4

 1.2 Generations.....4

 😊 1.3 Quick Guide.....5

 1.4 Words of wisdom.....6

CHAPTER 2 — GENERAL OPERATION 7

 2.1 **STEP 1** — GET SET UP7

 2.2 **STEP 2** — CONNECT UP AND COMMUNICATE8

 2.3 **STEP 3** — COMMUNICATE WITH COUNTER.....9

 2.4 USE SHUTTLE MODE13

 2.4.1 Overview13

 2.4.2 Instructions.....13

 2.4.3 Important dock information.....15

CHAPTER 3 — PRINT COUNTER'S INSTRUCTIONS (PART II) 16

 TRAFx Infrared Trail Counter

 TRAFx Vehicle Counter

 TRAFx OHV Counter

 TRAFx Mountain Bike Counter

CHAPTER 4 — SUPPORT 17

 4.1 Troubleshooting Table.....17

 4.2 Counter Test.....18

 4.3 Support FAQs.....18

APPENDIX 1 — LCD Tally Display Reset 19

APPENDIX 2 — USB Driver Confirmation 19

APPENDIX 3 — TRAFx Disc 19

APPENDIX 4 — General Specifications and Notices 19

TRAFx DataNet – Quick Guide (page 20)

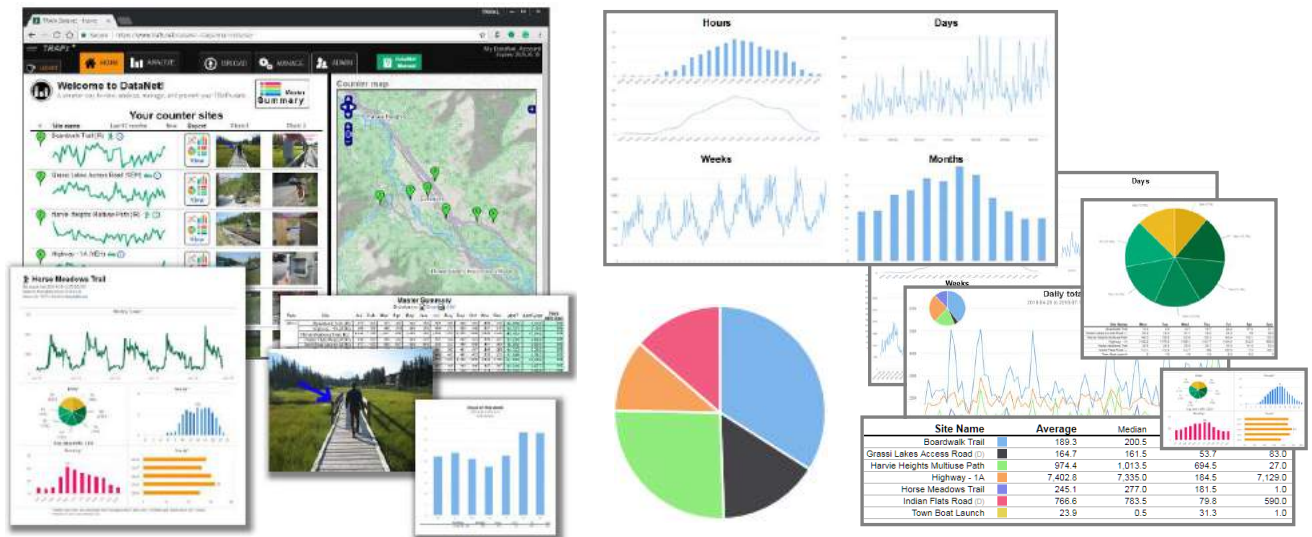

CHAPTER 1 — INTRODUCTION

1.1 Overview

TRAFx Research Ltd. designs and builds advanced counting systems. These systems are primarily for:

- Parks and public lands management
- Recreation studies
- Traffic and transportation studies
- Visitor studies

A TRAFx counting system consists of the following items:

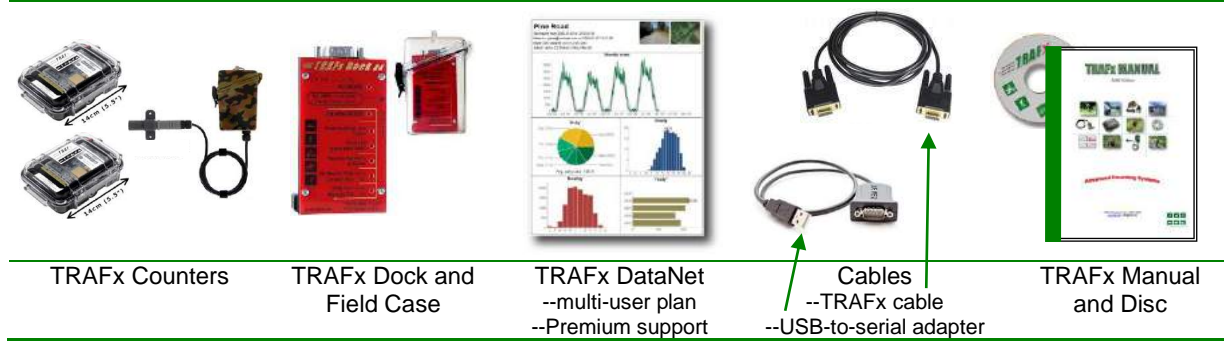

A TRAFx system covers all stages, from data collection to data analysis and management.

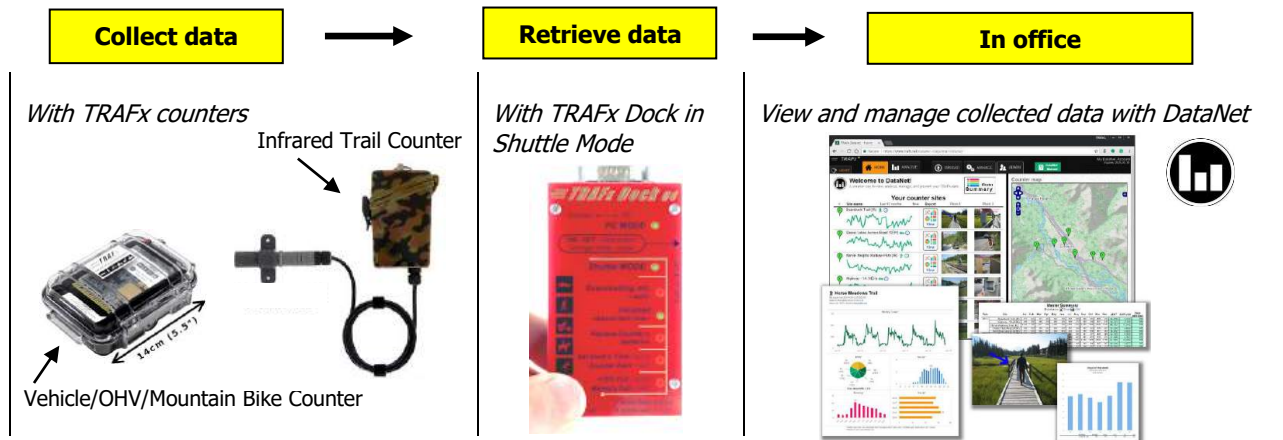

Once you learn how to use one type of TRAFx counter, the other types are very easy to learn — all TRAFx counters have a common hardware and software foundation, forming a coherent technology family.

1.2 Generations

TRAFx was founded in 2001. Though our designs have evolved and improved greatly over the years, backwards compatibility has been carefully maintained. For example, a G2 counter from 2005 is compatible with a G4 dock from 2021. Further, our DataNet software is compatible with all generations of TRAFx counters and docks, even those from 2001. Below is a brief historic overview.

G4 counter/dock	2017+
G3 counter/dock	2008
G2 counter/dock	2005
G1 counter/dock	2001

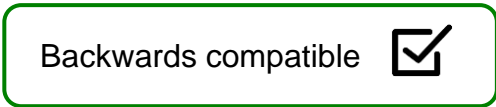

Quick Guide

This guide presents a streamlined way to use TRAFx counting equipment. Do 1 to 5 before going to the field. After counter installation, do 8 to 10 each time.



This page also serves as a handy reference for the overall process.

1 Connect up using PC



Before starting read page 6 --- these are important words of wisdom.

Then, carefully do pages 7 and 8. Here's a summary.

1. Put batteries in your counter and dock
2. Confirm dock is in **PC Mode**
3. Connect: **PC---cable(s)---dock---counter**
--if using the USB cable, install its driver first!
4. Open TRAFx Communicator and click GO!

2 Name counter/select mode

Using your PC's keyboard, enter "N" to name a counter and "S" to select mode. Remember to press the PC's **Enter** key (↵). See page 9.

3 Set Dock's time



See page 13 to configure the dock's time. Here's a summary.

1. Connect: **PC---cable(s)---Dock** in **Shuttle Mode**
2. Open TRAFx Communicator and click GO!
3. Enter "C" to configure (yy-mm-dd and 24hr time)
4. Press **Enter** (↵)

4 Print counter instructions

Now, jump ahead to page 16 and print out the required instructions that correspond to your counter type (e.g., vehicle, OHV, mountain bike, infrared trail counter).



5 Read counter instructions

After printing, follow the counter's instructions; the specified distances and other details are very important.

5

6 Install counter

Install counter in the field as per its instructions. Take a couple of photos of the site.



7 Launch counter

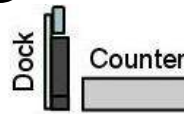

After installation, launch the counter otherwise no data will be recorded. Launching and downloading involve the exact same steps. Do steps 1 to 5 below.

8 Download counter

Here's how to use the dock's Shuttle Mode to download (and launch) a counter in the field after collecting data for a day, a week, a month, or more.

1. Confirm that the dock is in **Shuttle Mode**
2. Connect to a counter. "Downloading" should blink
3. Disconnect when "Finished" blinks
4. After disconnecting, the counter's red **Status LIGHT**★ should be blinking rapidly; this confirms a successful launch. If not, disconnect and repeat 2 and 3
5. Put a fresh desiccant pack inside the counter's case and close it

Go to the next counter. Repeat 1 to 5.



Before going to the field to download, confirm dock's:
(1) time is correct, (2) battery voltage is 3.4V or higher,
(3) old data is erased. See pages 13 to 15 for details.

9 Transfer data from Dock to PC

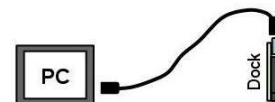

In your office, do as follows. See page 14 for details.

1. Connect: **PC---cable(s)---Dock** in **Shuttle Mode**
2. Open TRAFx Communicator and click GO!
3. Click **Download+** to save Shuttle file
--Save to your PC's desktop
4. Find Shuttle file (double click it to view it)
5. Lastly, enter "E" to erase dock

10 Use DataNet

The last step is to use DataNet to view your data. Go to pages 20 and 21 to learn how. Here's a summary.

1. Go to trafx.net to log in
2. **UPLOAD** Shuttle file and assign data to a counter site
3. **ANALYZE** and report data (i.e., generate totals, etc)



1.4 Words of wisdom

Please take a minute to read the following advice — it could save you a lot of time. Experience of other users has shown the following:



Overall approach

- ✓ Take a few hours to familiarize yourself with the equipment in the comfort of your office before heading out to the field.
- ✓ Follow the manuals carefully; you are learning how to do something new and unfamiliar. The **Quick Guide** on page 5 walks you through the entire process.
- ✓ This manual and the contents of the TRAFx Disc are available for free download at trafx.net/support. Ensure you are using current versions.
- ✓ Take the time necessary to select and prepare installation sites. **Do not rush this.** A well-selected and prepared site can be used year after year.
- ✓ After first installing a counter, return about a week later to do your first data download.
- ✓ After that, download monthly, if possible. This greatly reduces the risk of losing large amounts of data due to possible human error (e.g., incorrect installation), environmental conditions (e.g., a squirrel attacks the counter), technological issues (e.g., loose wire connection or weak batteries), and security issues (e.g., someone tampers with the equipment).
- ✓ Be sure to take the TRAFx manual to the field, and use the checklists provided in Part II.

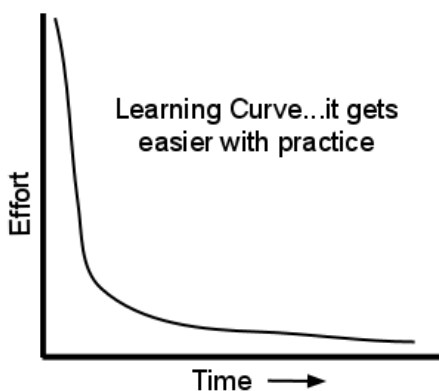

People



- ✓ Make one person in your organization responsible for learning how to operate TRAFx equipment well. This experienced person can then assist and supervise others, if necessary. **Having several users who rotate or only occasionally use the equipment is a formula for grief and trouble.** Avoid making short-term personnel (students, volunteers, seasonal staff, etc.) responsible for operating TRAFx equipment.



Learn from other user's mistakes

Why repeat other people's mistakes? Here are some.

1. Forgetting to install USB-to-serial adapter's driver software during initial setup.
2. Not following counter's installation instructions, especially the specified distances.
3. Forgetting to configure the Dock's clock after changing its batteries. 
4. Forgetting to (a) change counter's desiccant pack each time when downloading a counter, (b) store and transport the desiccants in a sealed container.



Desiccant packet (silica gel)
Visit trafx.net/support regarding size, type and where to buy

5. Sliding rather than pressing the dock's mode button (do not slide it).
6. Forgetting to disconnect dock from PC when finished (quickly drains dock's batteries). 

CHAPTER 2 — GENERAL OPERATION

This chapter consists of three steps and contains important information that applies to all TRAFx counter types and generations. Carefully work your way through it, even if you dislike manuals. Later, in Part II, use of specific counter types is covered.

What you need:

- Windows 10 / 11 desktop or laptop
 - Intel or AMD processor not ARM
- TRAFx Counter (and batteries)
- TRAFx G3 or G4 Dock (and batteries)
- TRAFx cable (and USB adapter cable)



2.1 STEP 1 — GET SET UP

The first step is to get things set up---the counter, the dock, and TRAFx Communicator.

A. TRAFx Counter

Put batteries in any TRAFx counter, carefully observing polarity (+ and -). The vehicle/OHV/mountain bike counter uses three alkaline "C" batteries; the infrared trail counter uses three alkaline "AA" batteries.

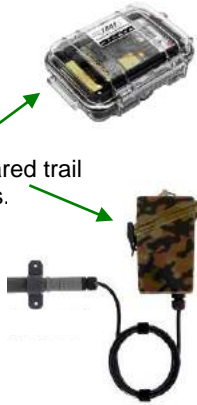

B. TRAFx Dock

Insert three alkaline AAA batteries into your dock (not rechargeables).

1. Remove battery holder's screw
2. Press down on lines and slide battery holder cover up
3. Insert three AAA batteries (e.g., Energizer), carefully obeying + and -
4. Replace cover and screw



Put your dock in **PC Mode** by gently pressing its mode button with your **finger nail**. The dock's **PC Mode LIGHT** should be blinking.



i When not connected to a PC, a G4 Dock automatically turns OFF after 5 minutes of inactivity, to save battery power.



C. TRAFx Communicator

To "talk" to (i.e., communicate) and configure your TRAFx counter and dock you need the TRAFx Communicator app (V4.1 is the current version).



TRAFx Communicator for Windows is on the TRAFx Disc. Or, download the latest version at: trafx.net/support



Find TRAFx Communicator and move it to your PC's desktop (or run it from the disc if you are not allowed to do this). You should see a hiker icon. Double click it to open and run it. You should see the screen below. If so, please proceed to the next page.

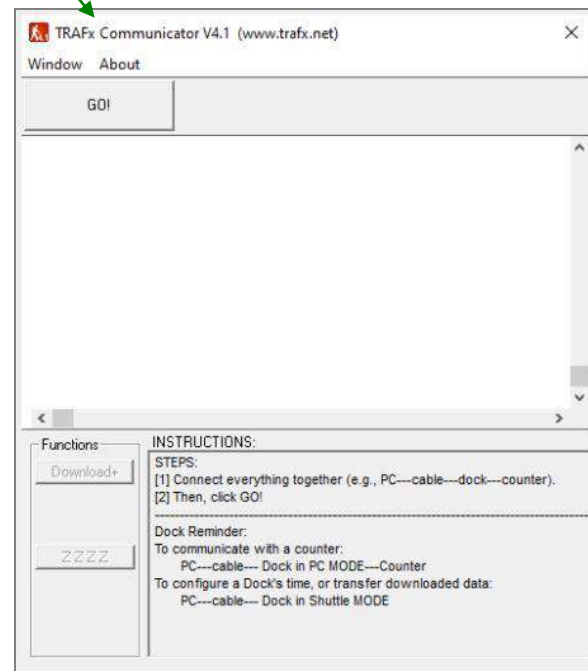

*If your PC completely blocks TRAFx Communicator, contact your IT staff, or whoever set up your PC. They will need to change your security settings to allow TRAFx Communicator to run. If they have concerns about TRAFx-related software, have them refer to: **TRAFx Overview for IT Staff** Download at: trafx.net/support*



2.2 STEP 2 — CONNECT UP AND COMMUNICATE

After putting batteries in your counter and dock, connect up (PC, dock and counter), using Option 1 or 2, to communicate with a counter. Ensure your dock is in **PC Mode**.



Option 1 Many government and corporate PCs have a 9-pin port (see left). Look carefully around the back of your computer for it. It offers the fastest and easiest way to connect up. Connect up as shown under Option 1 below.



Option 2 Only if your PC does not have a 9-pin port, use the supplied **USB-to-serial adapter**. But you must first confirm driver installation. See Appendix 2 on p. 19 for instructions. After confirming driver installation, connect up as shown under Option 2 below.

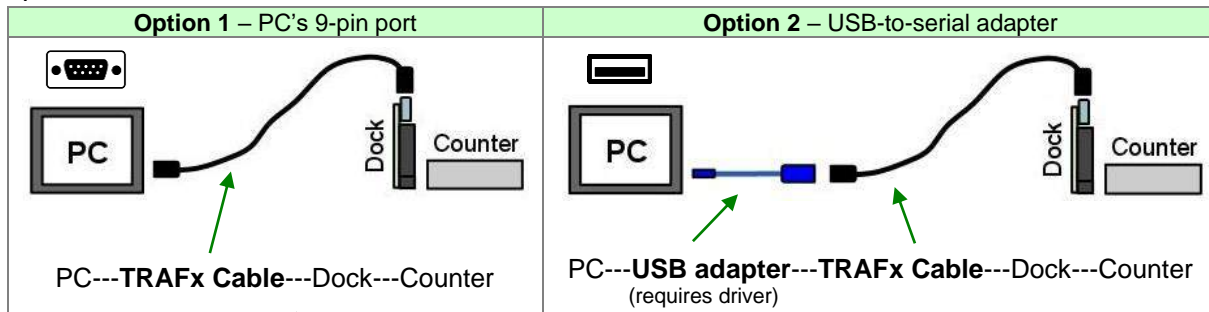

★ Need replacement cables? See Appendix 2 (p. 19)

Connecting dock & counter
Fully insert the counter's gold fingers into the slot on the back of the dock.
(hold firmly; it takes muscle)

Connect and disconnect straight in and out
← →
(not at an angle; not by wiggling)



Vehicle/OHV/MB Counter



Infrared Trail Counter

After connecting the PC, dock and counter together, click TRAFx Communicator's **GO!** button.

Text should now appear in the **main box**

You are now ready to communicate with a counter (go to next page).

- Troubleshooting tips appear in the **instruction box** if the connection fails; follow these if necessary.
- ★ If you click outside the **main box**, remember to click inside the main box to resume using TRAFx Communicator--you should see a blinking cursor.
- If you get stuck or lost when using TRAFx Communicator, just close it, re-open it, and start from the beginning again.

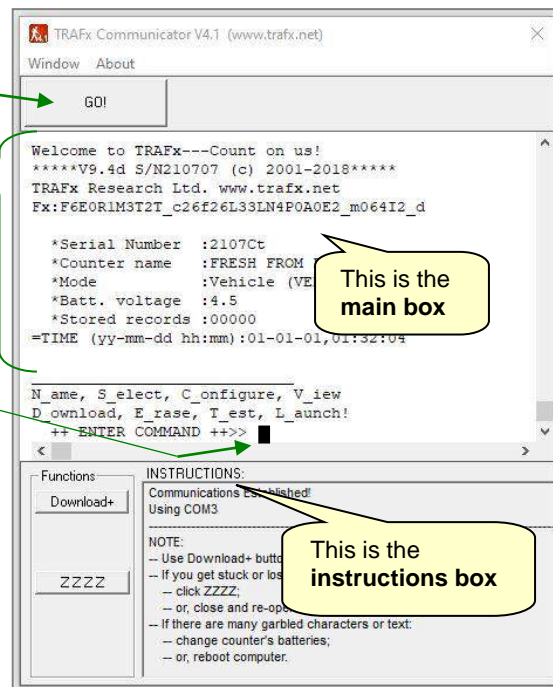

Still not working?
Use our Troubleshooting Wizard
at www.trafx.net/wizard

2.3 STEP 3 — COMMUNICATE WITH COUNTER

STEP 3 covers how to communicate with a TRAFx counter using a PC to name it, select a mode, change its settings, etc. This general information applies to all types and generations of TRAFx counters. Connect up as described on p. 8. Ensure your dock is in [PC Mode](#).

TRAFx Welcome Display

```
System check...

Welcome to TRAFx---Count on us!
*****V9.0d S/N210707 (c) 2001-2018*****
TRAFx Research Ltd. trafxf.net
Fx:F6E0R1M3T2T_c26f26L33LN4P0A0E2_m064I2

*Serial Number :2107AH
*Counter name :FRESH FROM FACTORY
*Mode :Vehicle (VEH-4d)
*Batt. voltage :4.5
*Stored records :00000
=TIME (yy-mm-dd hh:mm):01-01-01,01:08:36

N_ame, S_elect, C_onfigure, V_iew
D_ownload, E_rase, T_est, L_aunch!
++ ENTER COMMAND ++>>
```

After clicking GO! the first display you should see on your PC's screen is the **TRAFx Welcome Display**.

The PC's keyboard is used to enter letters and numbers to instruct a TRAFx counter what to do.



At the bottom of the TRAFx Welcome Display is a menu of commands. On your keyboard, enter the word's first letter to select the command and then press **Enter** (↵).

N_ame Enter N to name a counter

N

```
++ ENTER COMMAND ++> N
Counter name: FRESH FROM FACTORY
---enter value--> Cedar Road
```

i When possible, use geographic names

Enter **N** to give a counter a name. Use geographic names that correspond to the road or trail. Put a sticker on the counter with this name, too.

Enter a name for the counter using the PC's keyboard. The name may include both letters and numbers, to a maximum of 20 characters (but keep it under 10). After entering a name, press **Enter** (↵) on the PC's keyboard.

S_elect Enter S to select a counter mode (vehicle, infrared, etc.)

S

```
++ ENTER COMMAND ++> S

Select mode (single letter)
--see manual--
A:Vehicle (VEH-1s)
B:Vehicle (VEH-2s)
C:Vehicle (VEH-3s)
D:Vehicle (VEH-4d)
E:Vehicle (VEH-5d)
F:Infrared (IR+)
G:Pressure Pad (PP)
H:Mountain Bike (MB)
I:Air Tube (AT)
J:Off-highway Vehicle (OHV)
K:IR + Camera
L:Factory test
---enter value-->
```

Every TRAFx counter has a list of modes. When selecting a mode from the list ensure it matches your counter type.

After entering **S** a list appears. To select a mode, enter the mode's reference letter (A, B, C, etc.) and press **Enter** (↵).

TRAFx Vehicle/OHV/Mountain Bike Counter - normally enter D for vehicles; H for mountain bikes. and J for OHV (ATVs, quads)



TRAFx Infrared Trail Counter – enter F



(TRAFx Manual - Part II has more information on modes and their use.)

Each time a mode is selected, its default settings are freshly loaded.

Basic counter setup is now complete. Repeat the above for each counter. If you are following the **Quick Guide** go to page 13 now.

C

C_onfigure Enter C to configure counter settings

```

++ ENTER COMMAND ++> C

=TIME (yy-mm-dd hh:mm):21-11-30,14:18
  ---enter value-->
=START (yy-mm-dd hh:mm):21-11-27,07:00
  ---enter value-->
*Counter name :Cedar Road
*Mode :Vehicle (VEH-4d)
*Batt. voltage :4.5
*Stored records :00000

=TIME (yy-mm-dd hh:mm):21-11-30,10:19:06
=START (yy-mm-dd hh:mm):21-11-27,07:00
PERIOD (1/24/0=Timestamps) :001
DELAY (see manual) :008
THRESHOLD (see manual) :008
RATE (Fast/Slow) :S

Are settings above OK? (Yes/No):

PERIOD (1/24/0=Timestamps) :001
  ---enter value-->
DELAY :016
  ---enter value-->
THRESHOLD :008
  ---enter value-->
etc.

```

Enter **C** to configure (i.e., change) the counter's settings.

Upon entering "C" the first two settings you will see are **TIME** and **START**.

For now, skip by **TIME** and **START** by pressing the keyboard's **Enter** key (↵); the dock in Shuttle Mode automatically sets **TIME** and **START**, so you don't have to set these.

(**START** is the date/time at which data logging begins; see below).

Next a question appears: "Are settings above OK?"

To change the mode's settings (to better optimize a counter for a particular situation), enter "N" for No. After entering a new value, press the Enter key (↵). The counter instruction documents (p. 16) explain what the settings are for.

To leave a setting unchanged, just press the Enter key (↵) to skip by it.

After changing settings, all settings stream by again. This provides an opportunity to double check them.

**Jump to page 13 now**

- The rest of this chapter is for old G2 docks (2005 to 2007), or if using PC Mode in the field (not recommended).
- Shuttle Mode (see p. 13) automates what follows, greatly reducing risk of human error.

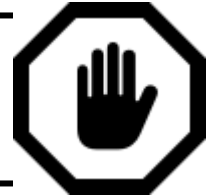

```

++ ENTER COMMAND ++> C

=TIME (yy-mm-dd hh:mm):21-11-30,14:18
  ---enter value-->
=START (yy-mm-dd hh:mm):21-11-27,07:00
  ---enter value-->
*Counter name :Cedar Road
*Mode :Vehicle (VEH-4d)
*Batt. voltage :4.5
*Stored records :00000

=TIME (yy-mm-dd hh:mm):21-11-30,10:19:06
=START (yy-mm-dd hh:mm):21-11-27,07:00
PERIOD (1/24/0=Timestamps) :001
DELAY (see manual) :016
THRESHOLD (see manual) :008
RATE (Fast/Slow) :S

Are settings above OK? (Yes/No):

```

To set the counter's time, first enter **C**.

Upon entering "C" the first setting you will see is **TIME**. In order for the counter to log data properly, it must have the current date/time.

TIME - Enter current date and time and then press the Enter key (↵). You must use the international, scientific format (year-month-day), with a 24hr clock (i.e., military time).

yy-mm-dd

Example: Nov 30th, 2021, 2:18pm = 21-11-30,14:18

START - Normally, do not enter a **START** time, as this will be determined automatically. To skip by this setting, press the Enter key (↵).

Note: If you remove or change the counter's batteries, you **must** re-enter **TIME** !!!

Info about START

- **START** is the date/time at which data logging begins.
- Upon entering "L" for Launch, or if using a TRAFx Dock in Shuttle Mode, **START** is automatically set to:
 - the top of the hour (e.g., 14:00) if using hourly totals (unless it is less than 5 minutes away, in which case the next top of the hour is selected).
 - 5 minutes after entering "L" for Launch, if using timestamps.
- ☆ However, you can enter your own **START** date/time (e.g., two days in the future), with a PC.
- If setting your own **START** date/time, always enter the top of the hour (e.g., 16:00) if using hourly totals; enter midnight (e.g., 21-11-30,00:00) if using daily totals.

V_view Enter V to view current mode settings

```

++ ENTER COMMAND ++> V

*Serial Number   :2107AH
*Counter name    :Cedar Road
*Mode            :Vehicle (VEH-4d)
*Batt. voltage   :4.5
*Stored records  :00000

=TIME (yy-mm-dd hh:mm):21-11-30,14:28:52
=START(yy-mm-dd hh:mm):21-11-27,07:00
PERIOD (1/24/0=Timestamps) :001
DELAY      (see manual)    :016
THRESHOLD (see manual)    :008
RATE (Fast/Slow)         :S

-----
N_ame, S_elect, C_onfigure, V_view
D_ownload, E_rase, T_est, L_aunch!
++ ENTER COMMAND ++>

```

Enter **V** to view the counter's current settings and other information, such as battery voltage, how many records are in the counter's memory, the counter's name, etc.

Remember: you must use yy-mm-dd, and 24 hour time (i.e., military time).

D_ownload Enter D to download all data stored in the counter's memory

D

```

++ ENTER COMMAND ++> D

Welcome to TRAFx---Count on us!
*****v9.0d S/N210707 (c) 2001-2018*****
TRAFx Research Ltd. trafxx.net
Fx:F6E0R1M3T2T_c26f26L33LN4P0A0E2_m064I2

*Serial Number   :2107AH
*Counter name    :Cedar Road
*Mode            :Vehicle (VEH-4d)
*Batt. voltage   :4.5
*Stored records  :00072

=TIME (yy-mm-dd hh:mm):21-11-30,15:06:02
=START(yy-mm-dd hh:mm):21-11-27,15:00
PERIOD (1/24/0=Timestamps) :001
DELAY      (see manual)    :016
THRESHOLD (see manual)    :008
RATE (Fast/Slow)         :S

Calibration: 03150
21-11-27,15:00,00944
21-11-27,16:00,01023
21-11-27,17:00,01286
etc.

END OF DATA
-close data file
-then check it

```

Enter **D** to download data.

To download and save data to a file click TRAFx Communicator's special **Download+** button (bottom left area). Communicator then automatically creates and names a file. Browse to where you want it saved on your PC and then click Save. The data is then dumped into the file. Find the file; to open it, double click it. (Try this, even without data.)

Header information (i.e., stuff located above the data), including settings used, automatically downloads before the stored data does.

Each line of data comprises one "record".

"END OF DATA" marks the end of the download.

E_rase Enter E to erase all data stored in the counter's memory

E

```

++ ENTER COMMAND ++> E

Confirm erase data (Yes/No):
Erasing data ...

```

Before erasing data ensure the data has been successfully downloaded and saved to a file. Open the file and inspect it.

Enter **E** to erase data in the TRAFx counter's memory. Confirm yes or no for this action. This reduces the risk of accidental erasure of field data. After downloading and saving data, erase it; do not let data accumulate in the counter's memory.

T_test Enter T to begin a test session

```

++ ENTER COMMAND ++> T

*Serial Number   :2107AH
*Counter name    :Cedar Road
*Mode            :Vehicle (VEH-4d)
*Batt. voltage   :4.5
*Stored records  :00000

=TIME (yy-mm-dd hh:mm):21-11-30,15:20:41
=START(yy-mm-dd hh:mm):21-11-27,15:00
PERIOD (1/24/0=Timestamps) :001
DELAY      (see manual)      :016
THRESHOLD (see manual)      :008
RATE (Fast/Slow)           :S

Are settings above OK? (Yes/No):

=====
Test to screen in progress...
-enter Z four times to end
21-11-30,15:20,
00001
00002
00003
etc.

```

Test is an optional feature that allows you to see data collection in real-time on a PC's screen, as actual counts occur.

Each counter's instruction document (p. 16) has detailed information regarding how to use Test. See this information when using it. For now you just need to know that Test exists.

L_launch! Enter L to launch a counter to collect data

L

```

++ ENTER COMMAND ++>> L

*Serial Number   :2107AH
*Counter name    :Cedar Road
*Mode            :Vehicle (VEH-4d)
*Batt. voltage   :4.5
*Stored records  :00000

=TIME (yy-mm-dd hh:mm):21-11-30,15:21:27
=START(yy-mm-dd hh:mm):21-11-30,16:00
PERIOD (1/24/0=Timestamps) :001
DELAY      (see manual)      :016
THRESHOLD (see manual)      :008
RATE (Fast/Slow)           :S

Are settings above OK? (Yes/No):

...5,4,3,2,1...BLAST OFF!!!

1-Remove counter from dock
2-Status LED still blinking rapidly?
3-long axis correctly oriented?
4-lid seal clean?
5-bag/container?
6-see manual for details

```

Enter L to launch a TRAFx counter for data collection.



Note: You must enter "L" to launch a counter. If "L" is not entered, then no data will be collected. Do not forget to enter "L" to launch the counter!

Upon entering "L" for launch, START automatically advances to a date/time in the future (see bottom of p. 10), when data collection will begin (unless you have entered your own START time).

Double check the settings, especially TIME, which must be the current date/time. If the settings are OK, then enter Y for Yes. Entering N for No cancels Launch!

After Launch! remove the counter from the dock. Check the Status LIGHT **S**. It must be blinking rapidly (4x/second) after removal from dock. If not, reinsert the counter into the dock, double check all settings, and try Launch again. Ignore the other lights for now.

Reconnecting the counter to the dock cancels the Launch!

Important: Erase all stored records (i.e., data) before launching the counter. If you forget to do this, you will be reminded during the Launch process.



Find the above confusing? Note that Shuttle Mode automates all this, greatly reducing the risk of human error. We strongly recommend you use Shuttle Mode instead. See next page.

2.4 USE SHUTTLE MODE

2.4.1 Overview

All G3 and G4 Docks have “Shuttle Mode”. Shuttle Mode provides an easy and convenient way to retrieve data from one or more counters in the field, without a laptop. Just connect the dock in Shuttle Mode to a counter and it downloads and launches the counter automatically. After you return to your office, transfer the downloaded data stored on the dock to a PC.

Advantages:

- The easiest and fastest way to download and relaunch a counter
- More compact, portable, rugged and easy to use in the field than a laptop.
- Much longer battery life (years for G4 Dock vs. only hours for laptops).
- Reduces human errors; automates the download and launch process.

2.4.2 Instructions

(This section assumes you have already completed pages 7 and 8).

1 Configure Dock's time

(If you have a counter connected to the dock, remove the counter from the dock now.)

The dock has a quartz clock for time keeping. You must configure (i.e., set) the dock's TIME, otherwise Shuttle Mode won't work. ★

1. Put your dock in **Shuttle Mode**, using your fingernail. (The Dock Alert LIGHT blinks as a reminder to set the dock's time).
2. Open **TRAFx Communicator**. Connect: PC---cable(s)---Dock

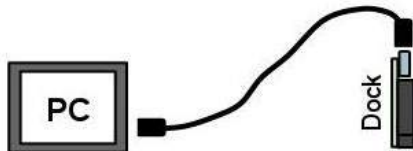

3. After clicking the GO! button you should see information about the dock, and the dock's menu at the bottom.

```

Dock: Shuttle Mode!
V 4.16 S/N210802 (c) 2017
TRAFx Research Ltd. trafxf.net
G4 Dock: _R2A-RI_B4.54_C0.00_F8127

Stored counter logs :0
Dock memory used (%) :0
Dock battery voltage :4.4

=DOCK TIME (yy-mm-dd hh:mm):!!! Invalid! Pl..
=====
C_onfigure, V_iew, D_ownload, E_rase
=====
++ ENTER COMMAND ++>>
    
```

Also note that the dock's battery voltage is displayed (replace batteries if < 3.4 volts).



Shuttle Mode

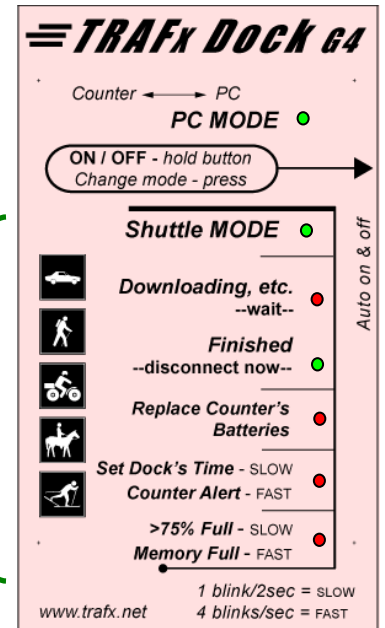

4. Enter “C” to configure the dock's TIME.

Input TIME, carefully noting the required format (yy-mm-dd and 24 hr time and press **Enter** (↵)).



yy-mm-dd

Eg: May 3rd, 2021, 5:00pm = 21-05-03 17:00

Note: 24hr time is also known as “military time”.
Examples: 9am = 09:00; 9pm = 21:00

Each time you change or remove batteries, you must configure the dock's time! ★

Dock setup is now complete. Disconnect the cable from the dock.

The dock can now be used as an autonomous “shuttle”. When connected to a counter the dock automatically:

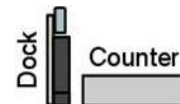

1. checks counter's batteries
2. downloads counter's data (if any)
3. erases counter's data (if any)
4. sets / updates the **counter's clock** ★
5. sets its START time
6. gets its diagnostic info
7. creates a counter log
8. launches counter

The diagnostic info is used by DataNet's powerful Diagnostic Tool.



2 Key Steps for the field

Here is a handy summary regarding Shuttle Mode and how to download / launch a counter in the field. Use this summary before going to the field and while there.



Shuttle Mode Key steps for the field

Don't forget to do this each time...

Before going to the field confirm that:

1. The dock's **TIME** is correct, (yy-mm-dd and 24 hr time).
2. The dock's battery voltage is **3.4** or higher (if not, replace dock's batteries and reconfigure **TIME**).
3. Erase old data stored in the dock's memory. Enter **E** for Erase.



Go to a counter in the field.



1. Confirm that dock is in **Shuttle Mode**.
2. Connect to a counter.
3. Do what the dock's **LIGHTS** indicate (see next page for **LIGHT** guide).
---If the **Replace Counter's Batteries** **LIGHT** blinks, disconnect, replace the counter's batteries and then reconnect.
- ★ 4. After disconnecting, the counter's **Status LIGHT** should be blinking rapidly; this confirms a successful launch. If not, repeat 2 and 3.
5. Put a fresh desiccant pack inside the counter's case.

Go to the next counter. Repeat 1 to 5.

If you are following the **Quick Guide** jump ahead to p. 16 now.



3 Transfer Dock's data to PC

After downloading data from counters in the field with Shuttle Mode, transfer this data from your dock to your office PC.

To transfer the counter logs stored in the dock's memory to your PC follow these steps:

1. Confirm dock is in **Shuttle Mode**.
2. Open **TRAFx Communicator**.
Connect: PC----cable(s)---Dock

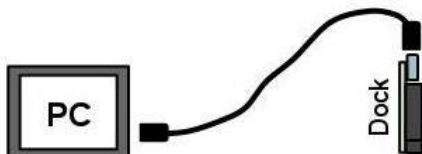

3. After clicking the **GO!** button you should see information about the dock, and the dock's menu at the bottom

```
Dock: Shuttle Mode!
V 4.16 S/N210802 (c)2017
TRAFx Research Ltd. trafxx.net
G4 Dock: _R2A-RI_B4.54_C0.00_F8127

Stored counter logs :0
Dock memory used (%) :0
Dock battery voltage :4.4

=DOCK TIME (yy-mm-dd hh:mm):21-04-30 16:00:28

=====
C_onfigure, V_iew, D_ownload, E_rase
=====
++ ENTER COMMAND ++>>
```

4. To download the dock, click on TRAFx Communicator's special **Download+** button and save to your PC's desktop. All the individual counter logs download together as a single **Shuttle file**.

The Shuttle file containing all the counter logs has now been transferred from the dock and saved as a file on the PC.



To confirm this, find the downloaded Shuttle File (where did you save it?) and click it to open it. **Notepad**, a program normally present on all PCs, should automatically open it.

- ★ After the Shuttle file has been transferred and saved to a PC, always erase all the counter logs stored in the dock's memory. Enter **"E"** for Erase.

```
++ ENTER COMMAND ++>> E

Permanently erase all counter logs
stored in dock? (Yes/No)
```

Enter **"Y"** to erase all counter logs.

The dock is now ready the next time you want to download data in the field. Lastly, disconnect dock from PC (otherwise dock's batteries quickly drain).

4 Use DataNet

So, you've downloaded and saved a Shuttle File and it is on your PC. What's next? The next step is to bring the Shuttle File into DataNet to see your totals, create summary tables and charts/graphs, etc. See pages 20 to 22.

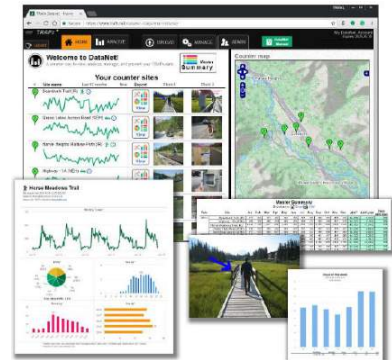

2.4.3 Important dock information

A. General

G3 Dock: released in 2008
G4 Dock: released mid-2017
What follows covers both.



B. Battery-related

Dock

- G3 Dock** (green)
 - 3 to 6 months bat. life
 - always on; always blinking
- G4 Dock** (red)
 - 4 to 6 years bat. life
 - ON/OFF button; also, auto-on (upon connection) and auto-off (after 5 minutes inactivity). Therefore, much longer battery life.



--After inserting batteries, configure the dock's TIME using a PC!! (see p. 13)
--Disconnect dock from PC when done (otherwise dock's batteries quickly drain).

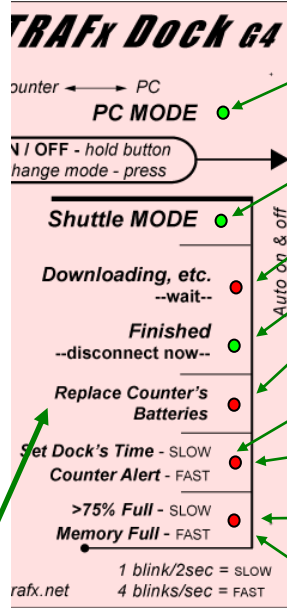

Comment	Blink Rate
PC MODE	
PC Mode	Slow
Counter detected; no PC	Fast
PC and counter detected	Solid
SHUTTLE MODE	
Shuttle Mode	Slow
PC detected	Solid
Downloading, launching, etc.	Fast
Wait! Do not disconnect!!!	
Finished. You can safely disconnect now	Fast
Low batteries. Disconnect counter, replace its batteries; then re-connect.	Fast
Dock Alert	Slow
Set dock's time using a PC (see p 13)	
Counter Alert (See Troubleshooting "c" below)	Fast
Memory 75% Full	Slow
Memory Full	Fast
Do not download anymore counters	

Slow = 1x/2sec Fast = 4x/1sec

Counter

- Replace Counter's Batteries** blinks when:
- G3 Dock - counter's voltage <3.3V (30%)
 - G4 Dock - counter's voltage <3.1V (15%)

If the **Replace Counter's Batteries** LIGHT blinks: (1) disconnect dock, (2) replace the counter's batteries, and (3) reconnect dock. See p. 14

If leaving a TRAFx Vehicle/OHV/Mountain Bike counter for a long time before returning again (i.e., approx. 2 months or more), give the counter new batteries regardless of whether **Replace Counter's Batteries** LIGHT comes on or not.



D. Notes

Shuttle Mode Menu Commands

- C** = C_onfigure dock's date/time
- V** = V_iew list of counter logs (connections)
- D** = D_ownload the dock to a PC
- E** = E_rase the dock

In winter, put the dock in its case and keep near your body.



Keep dock dry at all times. Immediately dry it (no batteries) with gentle heat if it becomes wet.



C. Shuttle Mode memory capacity

How many counters can the dock in Shuttle Mode download? That depends upon the amount and type of data they have.

Scenario	Dock storage capacity (approx.)	Download time per counter (approx.)	Records in counter memory
Hourly totals - 1 month	375 counters	7 secs	720
Hourly totals - 3 months	125 counters	21 secs	2160
Timestamps -1000	275 counters	10 secs	1000
Timestamps -Memory Full	20 counters	140 secs	14000

Download speed is roughly 100 records/second

E. Troubleshooting the Dock



- Dock not blinking?
 - G3 Dock: Replace dock's batteries
 - G4 Dock: Turn it on. Still not blinking? Replace dock's batteries.
 - (After, configure dock's time – see p. 13)
- If the dock does not react or function properly:
 - A. Soft-reboot** – hold in Mode button for 10 seconds (Still not working? Try B below).
 - B. Hard-reboot** – remove all batteries for 1 full minute. Reconfigure the dock's TIME with PC after reinserting its batteries!!
- If the **Counter Alert** LIGHT blinks, reboot the counter by removing and re-inserting its batteries. Still blinking? Replace the counter's batteries. If that does not fix the counter, do the counter test and inspection on p.18
- Still not working? See our Troubleshooting Wizard at www.trafx.net/wizard



CHAPTER 3 — PRINT COUNTER'S INSTRUCTIONS

(PART II)

Infrared Trail Counter

Each counter type has its own instruction document.

- TRAFx Infrared Trail Counter
- TRAFx Vehicle Counter
- TRAFx OHV Counter
- TRAFx Mountain Bike Counter

Carefully read the counter's instructions (settings, installation, maintenance, etc.) before using the counter. The instructions contain critical information regarding your counter(s).

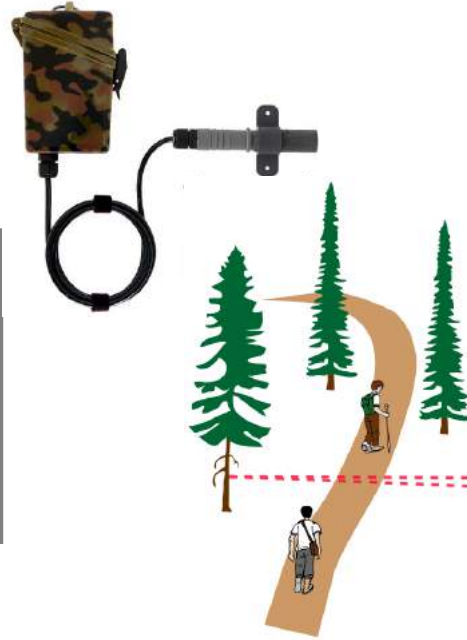

The counter's instruction document is on the TRAFx Disc, or download the current version at trafx.net/support Print it, hole punch it and add it to this manual. Read it before going to the field.



Print these

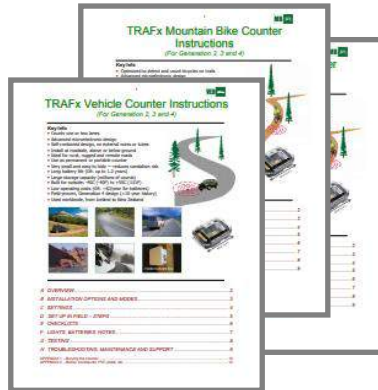
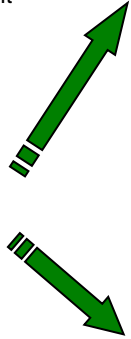

Vehicle, OHV, and Mountain Bike



Important: Want to detect both highway vehicles and OHVs? Always refer to the instructions of smallest vehicle type you want to detect (e.g., the TRAFx OHV Counter Instructions).



CHAPTER 4 — SUPPORT



Technical support, including by email and phone, starts at our website's support page at trafx.net. Please visit our website and click "Support" to begin the support process.

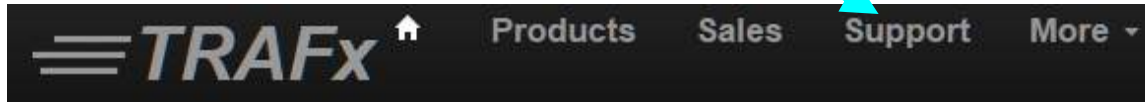







Once on our website's support page, you'll see the Support Hub. Click "Enter".

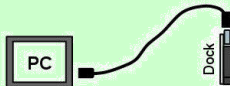

(Unable to visit our Support Hub? The tables and FAQs that follow address most support scenarios.)









4.1 Troubleshooting Table

#	Problem	How to resolve
1	PC / TRAFx Communicator problems <ul style="list-style-type: none"> I cannot "talk" with my dock (or counter) using my PC TRAFx Communicator does not work I have a new (or upgraded) PC. What do I do? 	Use Troubleshooting Wizard at trafx.net/support 
2	Dock problems <ul style="list-style-type: none"> My dock is not blinking / working Using Shuttle Mode, I connect to a counter but only Shuttle Mode blinks Counter/Dock Alert is blinking on my G3 Dock. Why? 	 See dock troubleshooting (p. 15) Try Troubleshooting Wizard See dock troubleshooting (p. 15) <ul style="list-style-type: none"> Reboot dock Set dock's time (p. 13)
3	Counter problems <ul style="list-style-type: none"> Missing data; stopped counting early Extremely high (>10,000/day) counts; or no counts Short battery life What am I doing wrong? What step did I forget? No lights blink on my counter My counter does not work with my dock Is my counter damaged or dead? Counts are moderately higher or lower than expected How do I make adjustments? 	Use DataNet's file diagnostic tool <ol style="list-style-type: none"> Login to DataNet UPLOAD > Diagnostics  Do counter test (see next page) See troubleshooting section in counter instructions (p. 16) 
4	Wrong date/time <ul style="list-style-type: none"> How I do I correct date/times in a data file? 	Use Date Correction Tool trafx.net/support 

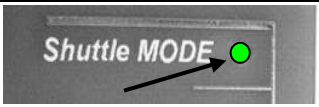
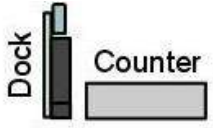

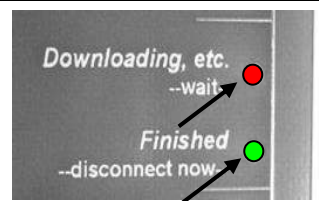
4.2 Counter Test

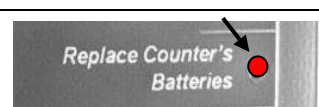
This quick and easy test confirms that your counter has battery power and that your dock is able to download / launch it. In other words, it confirms basic health. Please carefully do each step below.

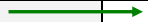
STEPS			Counter test		
1	 Confirm your G3 or G4 Dock is blinking in Shuttle Mode <ul style="list-style-type: none"> If the second light from the bottom also blinks, see p. 13; you need to set the dock's time first.  				
2	Connect dock to counter (<u>without</u> cable or PC).				
3	If "Downloading" blinks, and eventually "Finished", then your counter passes the basic health test.  <ul style="list-style-type: none"> If only Shuttle Mode blinks, reboot your dock. See p. 15 If it passes but still does not work properly see Q2 below. 				
4	If "Replace Counter's Batteries" blinks, do this: <ol style="list-style-type: none"> Disconnect counter from dock Remove old batteries from counter Insert new batteries Do Step 1, 2, and 3 again. 				
5	If "Replace Counter's Batteries" still blinks it means the counter is not getting battery power. Do the six-point counter inspection below.				
Counter Inspection					
6	 <ol style="list-style-type: none"> Inspect the batteries. Backward? Inspect the red and black battery wires. Disconnected? Inspect the six battery holder contact points. Dirty? Corroded? Inspect the counter's circuitboard. Moisture stress? Corrosion? Inspect the counter's 18 gold fingers. Any corrosion? Do you see anything else that looks suspicious? 				
7	Find something (1 to 6)? Feel free to email us via our Support Hub.  Provide photos of your counter's circuitboard and battery holder. Also, see Q1 below.	trafx.net/support			
Counter Maintenance					
8	See maintenance section in counter instruction documents (p. 9)				

4.3 Support FAQs

Q1: How do I get a counter (or dock) repaired?

If after having reviewed the above table, the counter (or dock) is still not working, email us via our Support Hub at trafx.net/support. We first need to determine whether or not it is repairable. A moisture-damaged and/or corroded counter circuitboard is usually not repairable. Ordering replacement parts is often the solution.

Q2: One of my counters is not working. What's the next step?

Do the counter test above. If it passes the test but still does not work properly, use DataNet's Diagnostic Tool (see #3 on p. 17).

Q3: How do I install my counter? How far away should I install it? Can you recommend a box?

All these questions are answered in the counter's instructions. See p. 16

Q4: I am taking over from someone else. What do I do? Where do I start?

Go to trafx.net/support and download TRAFx Manual - Part I and the applicable counter instructions. Carefully read both. Also, confirm the counters have been installed properly.

Q5: If I remove counter's (or dock's) batteries, do I lose my data?

No, your data is safe.

APPENDIX 1 — LCD Tally Display Reset

If you special ordered the factory installed LCD tally display, see its instruction document on the TRAFx Disc. Or, download at trafx.net/support

APPENDIX 2 — USB Driver Confirmation

When you connect the USB-to-serial adapter to a vacant USB port, Windows will usually attempt to automatically install the adapter's driver (takes about a minute and happens in the background). Do the steps below to confirm the driver is installed.



Requirements:

- Sewell USB-to-serial adapter (see below)
- Windows 10 or 11 desktop or laptop PC with an Intel or AMD processor (not ARM)



1. Plug the USB-to-serial adapter into a vacant USB port on your PC and wait a minute.
2. In your **Windows search box**, type: *Device Manager*
 - a. Click: *Device Manager*
 - b. Find and double click: *Ports*

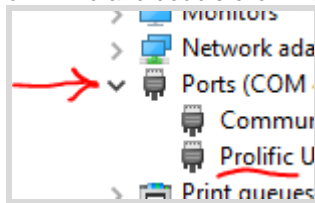

3. Do you see: **Prolific...**?
 - a. If yes, the driver is installed; return to page 8 now.
 - b. If no, unplug / plug adapter again.
 - i. Still not seeing: **Prolific...**?
Go to trafx.net/support and download "Driver instructions" and do Part A – Install driver.

Where do I buy replacement cables?

Only use the ones below; others often don't work!

USB-to-serial adapter

Sewell Part #: SW-1301

sewelldirect.com

amazon.com

--get "with posts" model



Or, google: ATEN UC232A

This one is fine too, as it uses the same driver.

TRAFx Cable

Null modem cable, 9-pin, F/F

Part #: P450-006

mouser.com



Or, google: SCNM9FF1MBK

This one is fine, too.

APPENDIX 3 — TRAFx Disc

Download the latest version of everything on the disc at trafx.net/support



APPENDIX 4 — General Specs and Notices

G4 Specs	Counters	Dock
Operating temp. (C)	-40 to 55	-20 to 55
Operating temp. (F)	-40 to 131	-4 to 131
Battery size	C and AA	AAA
Battery type	Alkaline	Alkaline
Battery max. temp. (C/F)	55 / 131	55 / 131
Battery life	See Part II	See p. 15
Voltage range	2.7 to 5	2.7 to 5
Communications	RS232	RS232
Communication speed	115.2K	115.2K
File type	ASCII / .txt	ASCII / .txt
Time keeping (@20C)	+/- 10ppm	+/- 10ppm
Circuitboard surface	Gold (ENIG)	Gold (ENIG)
Anti-moisture coating	Silicon	Silicon
EMI Compliance	FCC, IC, CE	FCC, IC, CE
Field case	Weatherproof	Weatherproof
Submersible	No	No

Notices

1. Carefully read and follow TRAFx Manual Part I and Part II before using TRAFx products.
2. Keep TRAFx equipment dry at all times.
3. Replace a counter's desiccants pack each time you download data.
4. Use safe field practices and precautions.
5. Happy counting!



Tip from the Count

Like many USB devices, you might occasionally need to unplug / plug the adapter from your computer's USB port, especially after not having used it for awhile to wake it up, or after restarting your computer.



TRAFx DataNet Quick Guide

DataNet is a comprehensive web-based solution to view, analyze, manage and present your TRAFx data. It is an essential part of your TRAFx counting system, and of a successful, efficient and effective counting project. Bottom line: it saves you time. DataNet reflects over a decade of design, development and refinement. Over a thousand organizations use it.



DataNet's highlights include:

- Comprehensive yet very easy to use
- Quickly generate totals, charts, reports, etc
- Makes data management simple
- Promotes "best practice"
- A multi-year DataNet plan for five users is included as part of your system package
- **Premium-level Tech Support** for your counters, docks, etc. is bundled with DataNet 
- Web-based (nothing to install or maintain)
- Login to your secure account from anywhere

How does DataNet fit in? After you have retrieved data from counters in the field, and you are back in your office, you upload the data file (e.g., Shuttle file) from your PC to DataNet.



Here is how to get started:

- 1** First, **learn** more about DataNet, using this guide and the online DataNet demo.
- 2** Second, **activate** your organization's subscription plan (next page). 

1 Demo

Go to trafx.net/datanet/demo, log in to the DataNet demo, and click along with this guide.

Each DataNet account allows two user types:

-  (1) **Administrators:** can do everything (upload data, create sites, delete data, add other users, etc.).
-  (2) **Viewers:** can generate totals, charts, reports, etc., but cannot add, delete or change things (upload data, delete data, remove other users, etc.).

For this demo, you are logged in as a **Viewer**.  Find **HOME** and **ANALYZE**. All users (Administrators and Viewers) will frequently use these.

HOME – Provides an overview: counter sites, reports, photos, master summary, a map, etc. When you upload new data, HOME automatically updates. 



Explore by clicking around: the icons, reports, photos, map markers, etc. The single-click, instant **Master Summary** (monthly rollup) is a favorite.

ANALYZE – It is here you generate charts (i.e., graphs), reports, and totals, and, if desired, export them and their source data. Follow the three easy steps: select site, date range, and report type. 

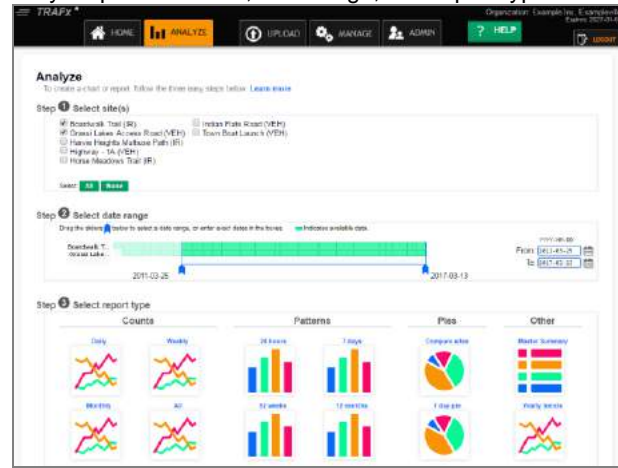

For practice, create five to seven different reports.



To export to Excel, just click on the Excel icon. 

The next three menu items (UPLOAD, MANAGE and ADMIN) are used by Administrators. As a Viewer, you can “see” but you cannot “do”.

UPLOAD – This page has two steps. First, you upload a file (e.g., Shuttle File), and then you assign its data to specific counter sites. To create a new counter site use the green box.

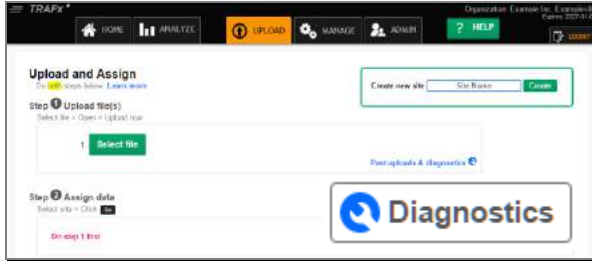

There is also a powerful file diagnostic tool to examine uploaded data for possible problems.

MANAGE – This is where you manage your counter sites and their associated information and settings (name, location, photos, data files, etc.). Also, new counter sites can be created here.



- Click a site to manage it. You can manage:
1. Site Info (name, location, photos, etc.)
 2. Data Options (adjustments, divide by 2, etc.)
 3. Data Sets (move, remove, export)

ADMIN – This is where an Administrator can add (and remove) other users. Administrators are responsible for adding (or removing) other users, not TRAFx.

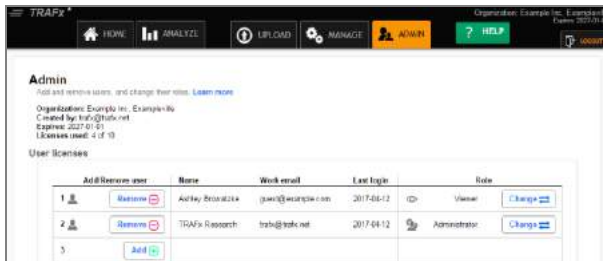

A new user can be added either as an **Administrator**, or a **Viewer**. Just follow the prompts. You can have multiple Administrators and multiple Viewers---this is up to you and your organization. As mentioned, Administrators have full privileges, whereas Viewers have fewer privileges.

The quick tour is now finished. For comprehensive information see DataNet’s Manual.



IMPORTANT: Although TRAFx backs up your DataNet data daily, store all your original data files in a safe place.

2 Activate

A TRAFx System Package includes a pre-paid multi-year plan for five DataNet users. DataNet’s activation code sticker is located below, in the original hardcopy manual that shipped with your TRAFx System Package.



If you cannot find your original manual and/or activation code, email us proof of purchase, through our Support Hub at trafx.net/support

Activation only needs to be done once by one person in your organization. That person automatically becomes an **Administrator** and can invite (add) other users, via DataNet’s **ADMIN** tab.

DataNet’s start-date was your system package’s ship date so there is no advantage to delaying activation. Also, by activating DataNet you enjoy **Premium-level Support** (see below). Additionally, equipment tips and reminders are available in DataNet.

To activate (i.e., unlock) the plan, please go to trafx.net/datanel/activate, enter the above activation code and follow the online instructions. Here is the overall process:

Enter activation code and your email > email verification occurs > create your organization’s DataNet account > register and read agreement > use DataNet

DataNet includes five DataNet user licenses. Each user (i.e., person) requires a license; email/password sharing is not allowed.

Premium-level technical support

DataNet users enjoy premium-level technical support (priority email response, and support by phone) for all their TRAFx equipment (counters, dock, DataNet, etc.), with their Premium Support ID. This ID is displayed in the upper right corner of DataNet, upon log in. Have it handy when contacting us.



All technical support begins at our **Support Hub** at trafx.net/support



DataNet Gallery

What can DataNet do? Below are just a few examples that can be created instantly.

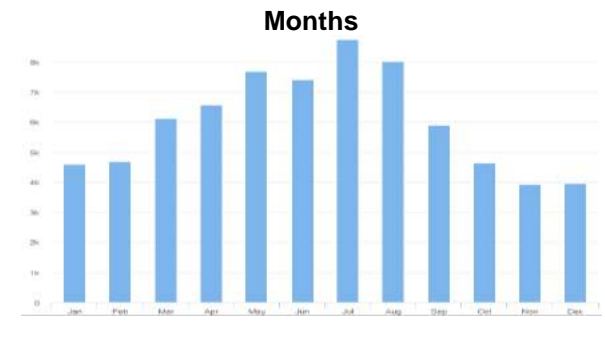
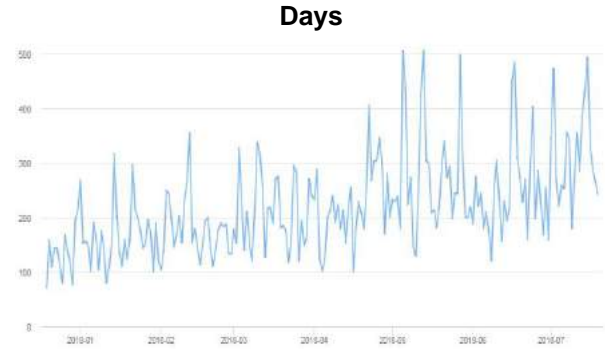
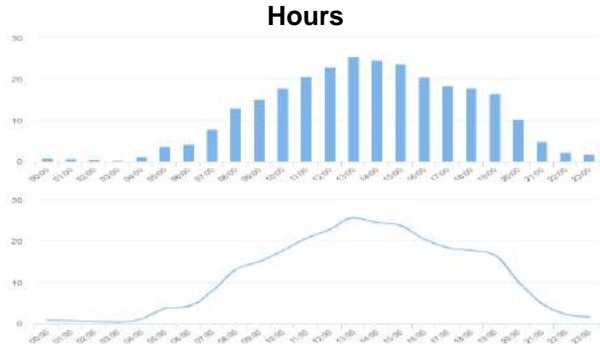

Monthly Totals Table (Master Summary)

Year	Site	Jan	Feb	Mar	Apr	May	Jun	Jul	Aug	Sep	Oct	Nov	Dec	ADT†	ADT†x365	Days with data
2015	Boardwalk Trail	32	0	23	205	822	1,043	1,263	1,427	1,225	1,094	667	238	22,025	8,039	365
	Grassi Lakes Access Road ^D	342	357	518	620	812	849	944	949	760	580	436	359	20,647	7,536	365
	Harvie Heights Multiuse Path	90	77	574	2,134	4,120	5,652	7,106	7,260	6,837	6,302	4,086	1,485	125,323	45,743	365
	Highway - 1A	28,891	25,958	28,538	27,957	28,034	28,049	29,811	29,758	28,832	28,355	27,176	28,782	931,893	340,141	365
	Horse Meadows Trail	0	0	54	546	1,422	1,724	1,904	2,057	1,860	1,688	1,092	344	34,770	12,691	365
	Indian Flats Road ^D	2,571	2,575	3,060	3,023	3,116	3,119	3,375	3,485	3,294	3,197	2,842	2,561	99,227	36,218	365
Town Boat Launch	0	0	0	0	18	83	209	303	268	124	5	0	2,767	1,010	365	
2016	Boardwalk Trail	57	1	27	287	837	1,212	1,558	1,467	1,442	1,253	722	292	25,014	9,155	366
	Grassi Lakes Access Road ^D	391	420	577	728	895	954	1,073	1,045	851	666	483	417	23,224	8,500	366
	Harvie Heights Multiuse Path	143	133	610	2,437	4,580	6,208	8,114	8,070	7,825	6,992	4,546	1,744	140,443	51,402	366
	Highway - 1A	30,014	28,746	30,715	29,198	30,256	29,650	30,636	32,300	30,674	29,697	29,447	30,226	987,866	361,559	366
	Horse Meadows Trail	0	0	47	498	1,333	1,584	1,943	1,908	1,786	1,575	1,030	319	32,850	12,023	366
	Indian Flats Road ^D	2,889	2,989	3,392	3,366	3,479	3,460	3,789	3,928	3,648	3,574	3,176	2,870	110,820	40,560	366
Town Boat Launch	0	0	0	0	13	103	287	318	304	150	4	0	3,221	1,179	366	
2017	Boardwalk Trail	68	1	33	340	891	1,365	1,717	1,648	1,675	1,369	830	350	28,184	10,287	365
	Grassi Lakes Access Road ^D	405	436	603	759	934	1,002	1,135	1,089	922	693	523	450	24,523	8,951	365
	Harvie Heights Multiuse Path	131	97	569	2,307	4,358	6,017	7,569	7,801	7,284	6,629	4,310	1,594	133,332	48,666	365
	Highway - 1A	33,669	30,363	34,098	32,228	33,792	32,577	34,441	36,183	33,292	33,587	32,871	33,085	1,095,847	399,984	365
	Horse Meadows Trail	0	0	60	573	1,363	1,848	2,027	2,092	2,070	1,703	1,169	351	36,318	13,256	365
	Indian Flats Road ^D	2,739	2,745	3,231	3,196	3,321	3,284	3,618	3,692	3,458	3,405	3,009	2,711	105,230	38,409	365
Town Boat Launch	0	0	0	0	7	99	262	273	279	122	4	0	2,866	1,046	365	

Compare multiple counters or different days of the week

